

Instructions for Exeter Dining Buffet

Unpack the buffet onto a soft level surface and identify the listed items.

Hardware included:

□ 4mm Allen wrench (1)

Exeter Dining Buffet:

6-EXE-50-04

72 1/2" x 19 7/8" x 33 1/2"H



Tools required

Allen wrench



When
in use

How to adjust the height of the drawer tray

The position of drawer tray can be adjusted with just a few steps:

Release the drawer slides

To remove drawer trays from the slides, reach under the drawer box, press both handles on the front slide clips on the drawer bottom and firmly pull drawer forward (**Figure 1**).

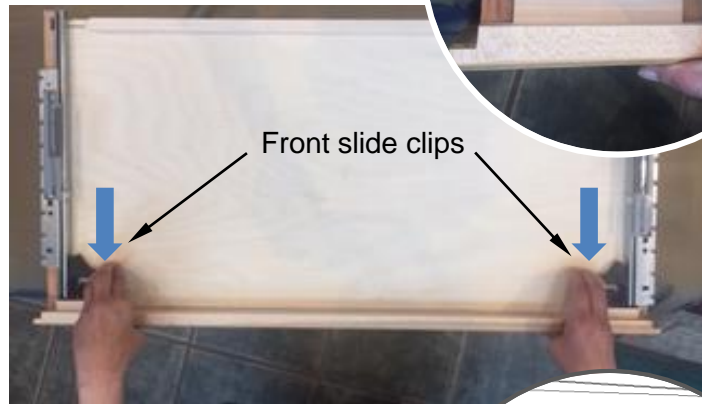

► **Figure 1.**
Release the drawer slides

Uninstall the *slide mounting block*

Using the provided Allen wrench detach the 1/4" - #20 x 35mm Allen bolts from the *slide mounting block* on both sides (**Figure 2**), then move the *slide mounting blocks* to the level where the drawer tray is going to be placed. Fasten the relocated *slide mounting blocks* with 1/4" - #20 x 35mm Allen bolts by aligning the holes on the *mounting block* with the pre-drilled holes on the case sides and middle.

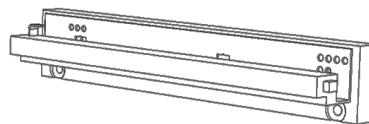

Slide Mounting Block

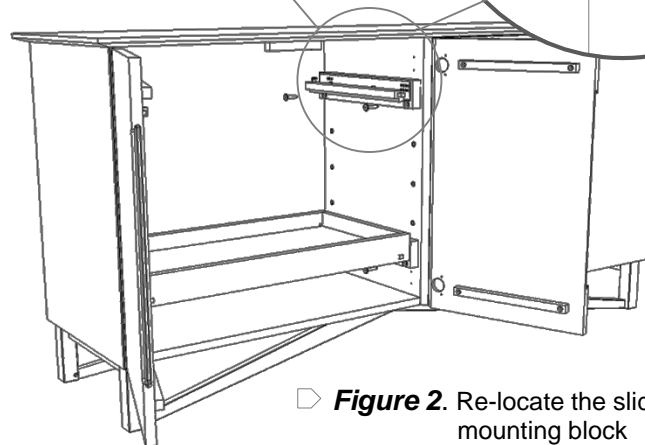

► **Figure 2.** Re-locate the slide mounting block



When
in use

How to level the case

2

To level the case, there are levelers in each of the four legs and a leveler in the middle leg. The levelers can be turned up and down to make the unit level.

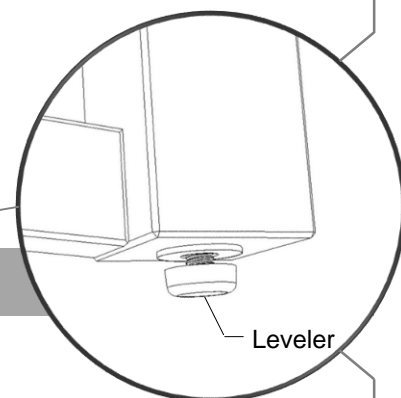
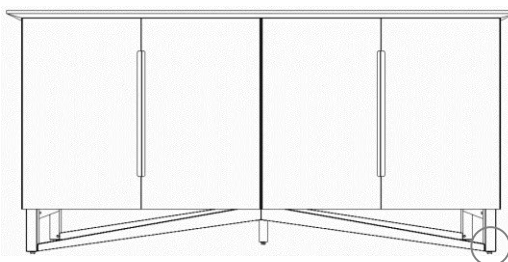

When
in use

How to level the drawer tray and buffet door

How to level the drawer tray

The drawer can be leveled by sliding the little button back and forth on each locking system of the drawer slides (**Figure 3a**).

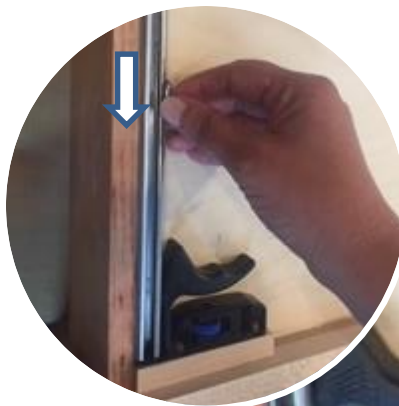

◇ **Figure 3b.** Attach the drawer slides

Attach the metal drawer slides

To attach metal slide, pull each slide end into the plastic locking system until you hear a locking sound. Make sure the drawer is level when you do this operation (**Figure 3b**).



◇ **Figure 3a.** Level the drawer by adjusting the slides.

How to level the doors

If your case has a door, it can be leveled by adjusting two hinges. There are three screws on each hinge and each can be adjusted independently (**Figure 4**). The first screw can adjust the door in the left and right direction. The second screw can adjust the door up and down. The third screw can move the door in and out. Please adjust your door accordingly.

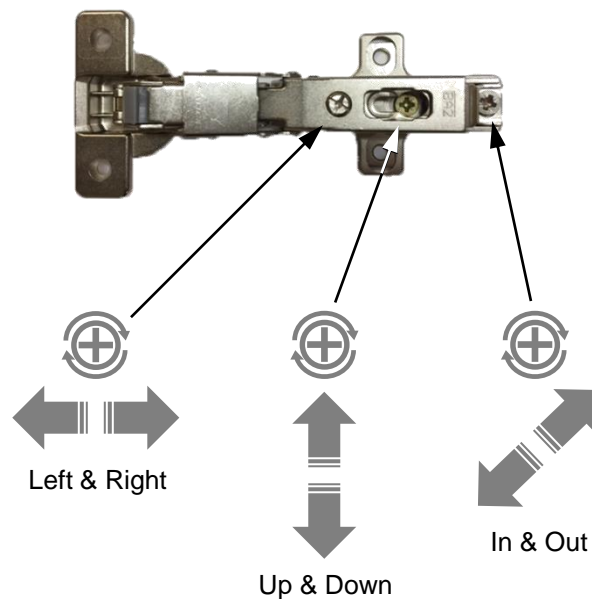

◇ **Figure 4.** Adjust the door(s) by turning the screws on the hinge accordingly.



Safety Notification

Copeland Furniture is in compliance with ASTM's volunteer Standard Safety Specification for Clothing Storage Units (2014 revision) – commonly known as the furniture tip-over standard. It is strongly recommended that you install the anti-tip stop included with your furniture to help prevent a potential top-over of the furniture onto a small child.

For more information, please visit www.astm.org/Standards/F2057.htm.

Care Instructions

To care for and preserve the finish on your new Copeland Furniture piece, please keep the following recommendations in mind.

- While our furniture has been finished with a durable top coat, the surface may be sensitive to dents and abrasions during the first 30 days in your home.
- Treat the surface finish gently so it does not dent or chip. Tape or stickers should not be put on the finish.
- For general care use a soft cloth to dust the furniture.
- Use damp cloth with a mild soap to clean-up spills or dirt. Dry the surface thoroughly.
- Please do not use any polishes, waxes or solvents to clean the surface of the furniture. This holds true for new Copeland Furniture pieces as well as items you may already have in your home.
- Please do not place any candles directly on the surface of your furniture. The perfumes and dyes in the candles may penetrate the finish.
- Beds must be disassembled before moving to avoid damage. Never attempt to move the bed while it is assembled.

Special Care Instructions for Cherry Furniture

Please read the following if you have purchased a Copeland product in cherry. Furniture that has been crafted from cherry wood becomes darker with age. The change in color, from a reddish tan to a reddish brown, is most noticeable during the first six months of ownership. It is important to understand that exposure to light accelerates the natural oxidization process. An object left on a cherry wood surface for an extended period of time may retard the aging process in a limited area. Simply remove the object and, over time, the surface will attain a uniform reddish brown color.

